 GMDN Code 10941	TECHNICAL DATA SHEET	408702 en	Date: 13/09/10
		Revision 1	Page 1 of 3

Codos: 408702, 408726, 408702.G, 408726.G
Urine container 120ml for vacuum tubes



New in 2010 catalogue

Code	Description	Case quantity	Case weight (Kg)	Case volume	Cases palet
408702	Non sterile. In bulk	475	9.60	0.14	16
408726	Non sterile. Individually wrapped	350	7.50	0.14	16
408702.G	Sterile by radiation. In bulk	250	5.05	0.082	24
408726.G	Sterile by radiation. Individually wrapped	350	7.50	0.14	16

Sanitary Product. IVDD 98 / 79 / CE

SPECIFIC USE

Container to store biological fluids from the human body (urine) and transport to the laboratory for In vitro analysis. Used in hospitals and laboratories.

DESCRIPTION

Manufactured in transparent Polypropylene and designed to use with vacuum collection tubes.

Leakproof cap, with an internal obturating ring, moulded. It includes a cannula with a needle inside protected by a rubber cap and a plastic suction nozzle. The cap features a label that seals the cannula in order to prevent contact with the collection needle.

The container features a wide marking area for sample identification and a graduation that helps to quantify the sample when uncapped. Once capped, the graduation is inaccurate as the volume is altered by the cannula.

- Code 408702: non sterile, is supplied in bulk.
- Code 408726: non sterile, is supplied individually wrapped and printed with instructions for use, lot and expiration.
- Code 408702.G: is sterile and supplied in bulk; each container is marked with sterilization method, lot and expiration date.
- Code 408726.G: is sterile and is supplied individually wrapped and printed with instructions for use, lot, expiration, and sterilization method.

Elaborated	Verified	Approved
		

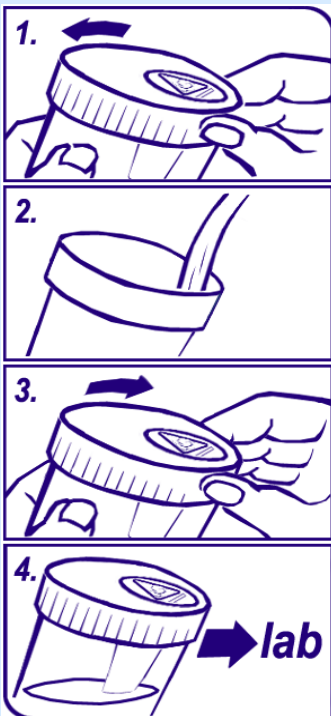
Instructions for sampling:

1. Open the urine container and place cup upright on clean flat surface.
2. Collect the middle of specimen, discarding the beginning and the end of the urine.
3. Close the container carefully in order to avoid touching the inner part of the cup.
4. Give the urine container to the healthcare worker or nurse.

Instructions for extraction by vacuum tube:

1. Remove the cap label carefully and place cap upright on a clean, flat surface.
2. Place evacuated tube into cavity on cap, stopper down.
3. Advance the tube over puncture point to pierce stopper. The urine tube will be filled. Repeat if another tube is to be collected. Hold tube in position until filled and remove tube from device.
4. Hold tube in position until filled and remove tube from device. Replace label over hole and reseal. Label the tube for transport to the laboratory.

Elaborated	Verified	Approved
		

DIMENSIONS AND CAPACITIES

DIMENSIONS (mm)	External diameter of the urine container	56.3	A
	External diameter of the cap	62.1	B
	Top cannula internal diameter	19.5	C
	Lower cannula internal diameter	17.7	D
	Total length	74.3	E
CAPACITIES (ml)	Maximum volume without cap	145	
	Maximum volume with cap	120	
	Recommended volume	60	

COMPONENTS



CANNULA WITH NEEDLE

STICKER CAP

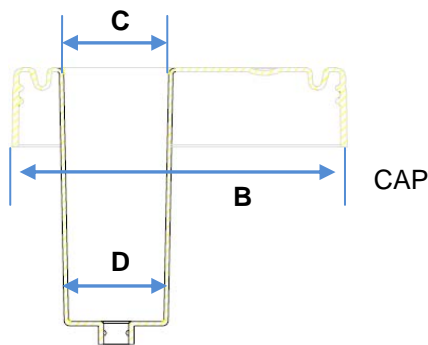

CAP

COMPLETE SET

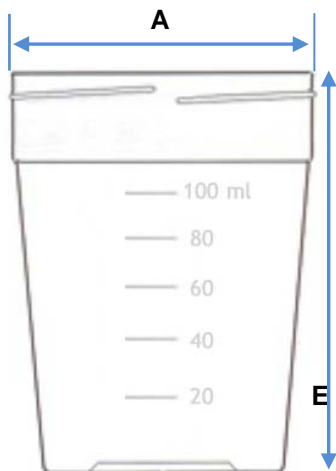

URINE CONTAINER



Elaborated	Verified	Approved